



Applications

- Drainage of wastewater from the attenuation tank, purifying tank and sewage tank in water treatment plant
- Drainage of waste water containing fibrous additives from leather factory and food processing factory.
- Sewage management, accumulated water, septic tank, stock farm.
- Pumping sewage form hotels, restaurants, schools and public buildings

Pump

- High-efficiency & anti-clogging enclosed channel impeller
- Flexible installations with hoses, pipes or quick-coupling systems
- Float switch as standard accessory for single phase (≤1.1kw)
- Double-end mechanical seal
- Stainless steel welded shaft
- Liquid temperature: 0 - 40 °C
- Liquid PH value: 4 - 10
- Max. immersion depth: 5 m

Motor

- Frequency/Pole number: 50 Hz/2
- Insulation class: F
- Protection class: IPX8
- Bearing: Ball type

Identification Codes

50 SW E m 8 - 16 - 1.1



Technical Data

Model		Power		Discharge mm (inch)	Rated Flow (m³/h)	Max. Flow (m³/h)	Rated Head (m)	Max. Flow (m³/h)	Solid Passage (mm)
Single Phase	Three Phase	kW	HP						
50SWE8-16-1.1	50SWE8-16-1.1	1.1	1.5	50 (2")	8	26	16	19	15
50SWE8-20-1.5	50SWE8-20-1.5	1.5	2	50 (2")	8	25	20	22	15
50SWE15-20-2.2	50SWE15-20-2.2	2.2	3	50 (2")	15	45	20	23	25
-	50SWE15-25-3	3	4	50 (2")	15	45	25	23	25

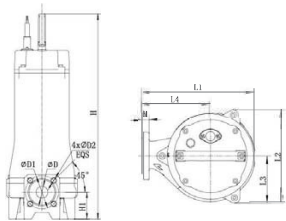

Dimension

Model	L1	L2	L3	L4	H	H1	D	D1	D2	M
50SWE8-16-1.1					559					
50SWE8-16-1.1	223	191	96	135		88	50	110	14	16
50SWE8-20-1.5					586					
50SWE8-20-1.5					627					
50SWE15-20-2.2					570					
50SWE15-20-2.2	270	223	113	163		75	50	110	14	16
50SWE15-25-3					559					

Hydraulic Performance Curves

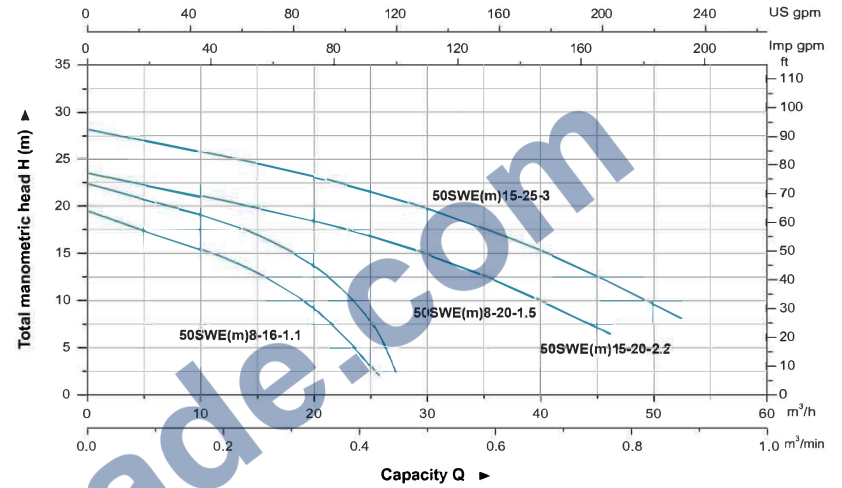

Materials Table

No.	Part	Material
1	Handle	ZG304
2	Upper cover	HT200
3	Upper bearing seat	HT200
4	Motor body	HT200
5	Oil chamber	HT200
6	Pump cover	HT200
7	Pump body	HT200
8	Impeller	HT200
9	Oil seal	
10	Mechanical seal	Upper Silicon Lower SiC/SiC
11	Bearing	
12	Rotor	
13	Stator	

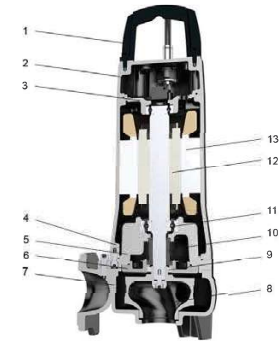

Package Information

Model	GW (Kgs)	L (mm)	W (mm)	H (mm)	Quantity (PCS/20 TEU)
50SWE8-16-1.1	39.3	750	290	368	372
50SWE8-16-1.1	42.5	750	290	368	372
50SWE8-20-1.5	50.5	848	358	311	294
50SWE8-20-1.5	53	848	358	311	294
50SWE15-20-2.2	56	848	358	311	294
50SWE15-20-2.2	57	848	358	311	294
50SWE15-25-3	62	848	358	311	294

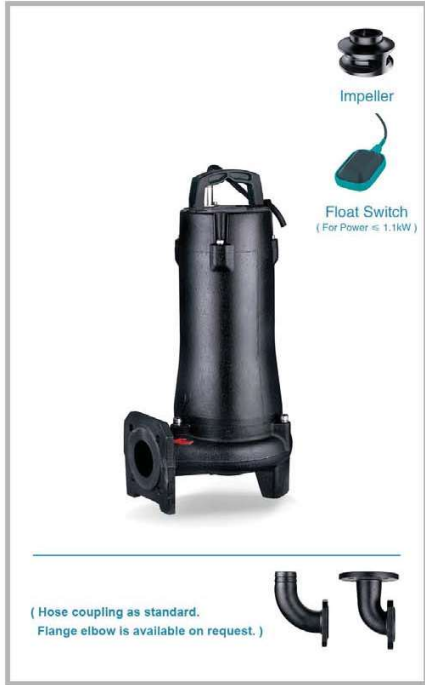

Applications

- Drainage of wastewater from the attenuation tank, purifying tank and sewage tank in water treatment plant
- Drainage of waste water containing fibrous additives from leather factory and food processing factory.
- Sewage management, accumulated water, septic tank, stock farm.
- Pumping sewage form hotels, restaurants, schools and public buildings

Pump

- High-efficiency & anti-clogging enclosed channel impeller
- Flexible installations with hoses, pipes or quick-coupling systems
- Float switch as standard accessory for single phase (≤1.1kw)
- Double-end mechanical seal
- Stainless steel welded shaft
- Liquid temperature: 0 - 40 °C
- Liquid PH value: 4 - 10
- Max. immersion depth: 5 m

Motor

- Frequency/Pole number: 50 Hz/2
- Insulation class: F
- Protection class: IPX8
- Bearing: Ball type

Identification Codes

65 SW E m 15 - 10 - 1.1

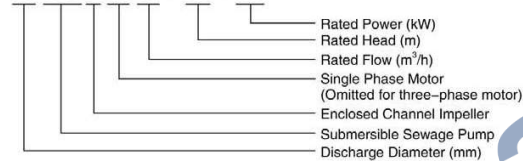

Hydraulic Performance Curves

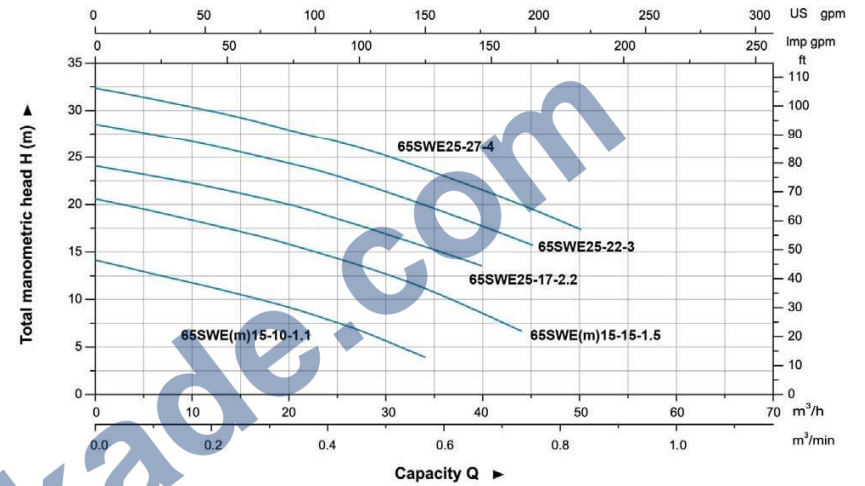

Materials Table

No.	Part	Material
1	Handle	ZG304
2	Upper cover	HT200
3	Upper bearing seat	HT200
4	Motor body	HT200
5	Oil chamber	HT200
6	Pump cover	HT200
7	Pump body	HT200
8	Impeller	HT200
9	Oil seal	
10	Mechanical seal	Upper:SiC/Carbon Lower:SiC/SiC
11	Bearing	
12	Rotor	
13	Stator	

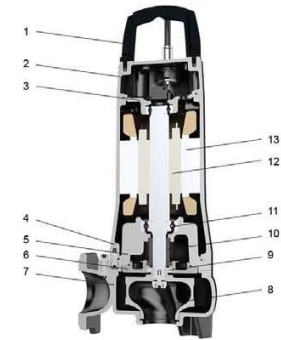

Technical Data

Model		Power		Discharge mm (Inch)	Rated Flow (m³/h)	Max. Flow (m³/h)	Rated Head (m)	Max. Flow (m³/h)	Solid Passage (mm)
Single Phase	Three Phase	kW	HP						
65SWE15-10-1.1	65SWE15-10-1.1	1.1	1.5	65 (2.5")	15	34	10	14	25
65SWE15-15-1.5	65SWE15-15-1.5	1.5	2	65 (2.5")	15	44	15	20	25
-	65SWE25-17-2.2	2.2	3	65 (2.5")	25	40	17	24	25
-	65SWE25-22-3	3	4	65 (2.5")	25	45	22	28.5	25
-	65SWE25-27-4	4	5.5	65 (2.5")	25	50	28	33	25

Dimension

Model	L1	L2	L3	L4	H	H1	D	D1	D2	M
65SWE15-10-1.1					557					
65SWE15-10-1.1					581					
65SWE15-15-1.5					622	85	65	130	14	16
65SWE15-15-1.5	291	226	117	178	622					
65SWE25-17-2.2					581					
65SWE25-22-3					610					
65SWE25-27-4					610					

Package Information

Model	GW (Kgs)	L (mm)	W (mm)	H (mm)	Quantity (PCS/20'TEU)
65SWE15-10-1.1	46	750	290	368	372
65SWE15-10-1.1	48	750	290	368	372
65SWE15-15-1.5	57	848	290	368	372
65SWE15-15-1.5	60	848	290	368	372
65SWE25-17-2.2	61	848	358	311	294
65SWE25-22-3	67	848	358	311	294
65SWE25-27-4	68	848	358	311	294



Applications

- Drainage of wastewater from the attenuation tank, purifying tank and sewage tank in water treatment plant
- Drainage of waste water containing fibrous additives from leather factory and food processing factory.
- Sewage management, accumulated water, septic tank, stock farm.
- Pumping sewage form hotels, restaurants, schools and public buildings

Pump

- High-efficiency & anti-clogging enclosed channel impeller
- Flexible installations with hoses, pipes or quick-coupling systems
- Double-end mechanical seal
- Stainless steel welded shaft
- Liquid temperature: 0 - 40 °C
- Liquid PH value: 4 - 10
- Max. immersion depth: 5 m

Motor

- Frequency/Pole number: 50 Hz/2
- Insulation class: F
- Protection class: IPX8
- Bearing: Ball type

Identification Codes

80 SW E 40 - 9 - 2.2

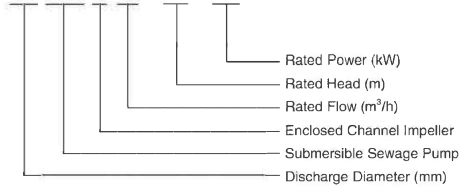

Technical Data

Model	Power		Discharge mm (inch)	Rated Flow (m³/h)	Max. Flow (m³/h)	Rated Head (m)	Max. Head (m)	Solid Passage (mm)
	kW	HP						
80SWE40-9-2.2	2.2	3	80 (3")	40	69.5	9	17	30
80SWE40-13-3	3	4	80 (3")	40	76	13	21	30
80SWE40-18-4	4	5.5	80 (3")	40	83	18	23	30

Dimension

Model	L1	L2	L3	L4	H	H1	D	D1	D2	M
80SWE40-9-2.2	266	224	113	160	594	86	80	150	18	18
80SWE40-13-3	266	224	113	160	620	86	80	150	18	18
80SWE40-18-4	266	224	113	160	620	86	80	150	18	18

Hydraulic Performance Curves

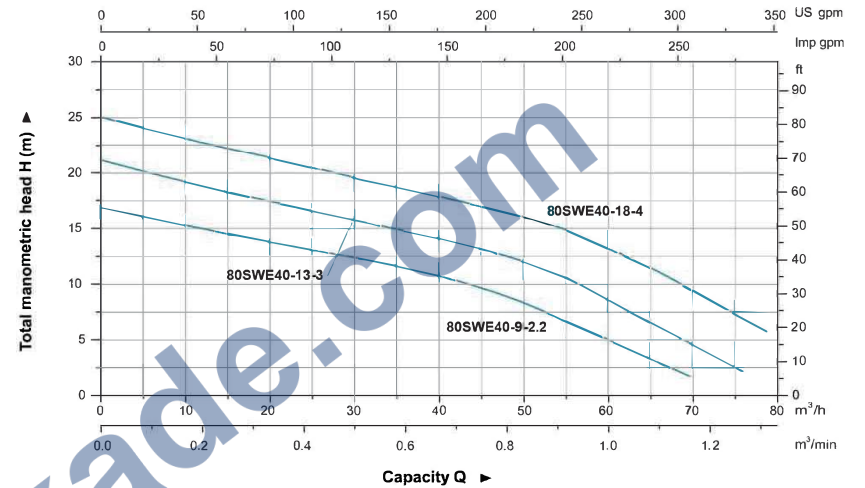

Materials Table

No.	Part	Material
1	Handle	ZG304
2	Upper cover	HT200
3	Upper bearing seat	HT200
4	Motor body	HT200
5	Oil chamber	HT200
6	Pump cover	HT200
7	Pump body	HT200
8	Impeller	HT200
9	Oil seal	
10	Mechanical seal	Upper Sic/Carbon Lower Sic/Sic
11	Bearing	
12	Rotor	
13	Stator	

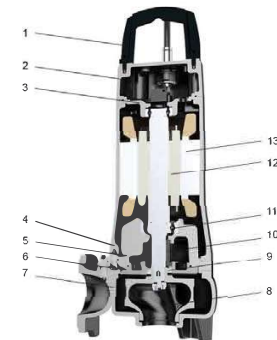

Package Information

Model	GW (Kga)	L (mm)	W (mm)	H (mm)	Quantity (PCS/20' TEU)
80SWE40-9-2.2	70	848	358	311	294
80SWE40-13-3	68.5	848	358	311	294
80SWE40-18-4	62	848	358	311	294



Applications

- Drainage of wastewater from the attenuation tank, purifying tank and sewage tank in water treatment plant
- Drainage of waste water containing fibrous additives from leather factory and food processing factory.
- Sewage management, accumulated water, septic tank, stock farm.
- Pumping sewage form hotels, restaurants, schools and public buildings

Pump

- Semi-open vortex impeller, suitable for liquid containing impurities and long fiber substance
- Flexible installations with hoses, pipes or quick-coupling systems
- Float switch as standard accessory for single phase (≤1.1kw)
- Double-end mechanical seal
- Stainless steel welded shaft
- Liquid temperature: 0 - 40 °C
- Liquid PH value: 4 - 10
- Max. immersion depth: 5 m

Motor

- Frequency/Pole number: 50 Hz/2
- Insulation class: F
- Protection class: IPX8
- Bearing: Ball type

Identification Codes

50 SW U m 9 - 6 - 0.37

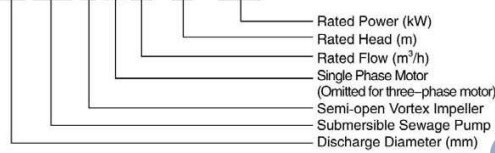

Technical Data

Model		Power		Discharge mm (inch)	Rated Flow (m³/h)	Max. Flow (m³/h)	Rated Head (m)	Max. Flow (m³/h)	Solid Passage (mm)
Single Phase	Three Phase	kW	HP						
50SWUm9-6-0.37	50SWU9-6-0.37	0.37	0.5	50 (2")	9	19	6	9.5	35
50SWUm13.2-4-0.37	50SWU13.2-4-0.37	0.37	0.5	50 (2")	13.2	22	4	6	50
50SWUm12-8-0.75	50SWU12-8-0.75	0.75	1	50 (2")	12	22.5	8	13	35
50SWUm15-5.5-0.75	50SWU15-5.5-0.75	0.75	1	50 (2")	15	27	5.5	9	50

Dimension

Model	L1	L2	L3	L4	H	H1	D	D1	D2	M
50SWU9-6-0.37					560	75				
50SWUm9-6-0.37										
50SWUm13.2-4-0.37					575	80				
50SWUm13.2-4-0.37	203	178	89	121			50	110	14	16
50SWU12-8-0.75					560	75				
50SWUm12-8-0.75										
50SWU15-5.5-0.75					575	80				
50SWUm15-5.5-0.75										

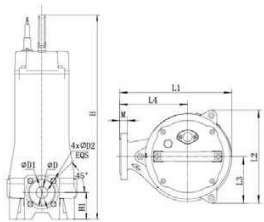

Hydraulic Performance Curves

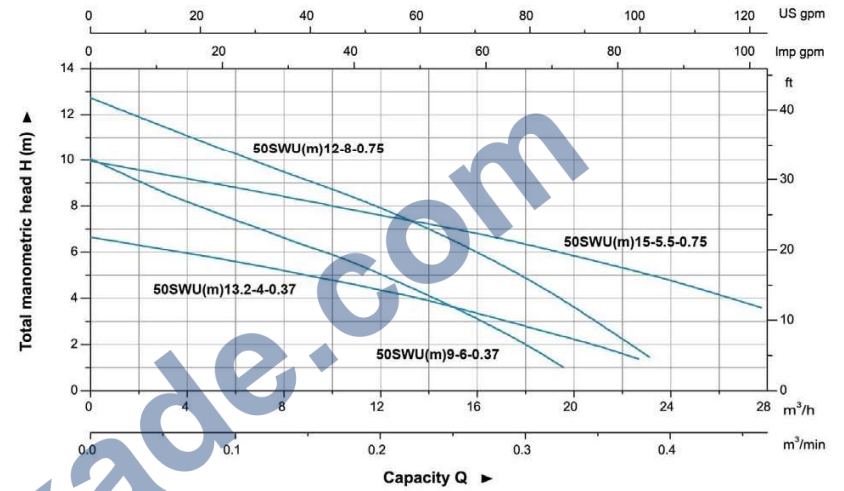

Materials Table

No.	Part	Material
1	Handle	ZG304
2	Upper cover	HT200
3	Upper bearing seat	HT200
4	Motor body	HT200
5	Oil chamber	HT200
6	Pump cover	HT200
7	Pump body	HT200
8	Impeller	HT200
9	Oil seal	
10	Mechanical seal	Upper:Carbon Lower:SiC
11	Bearing	
12	Rotor	
13	Stator	

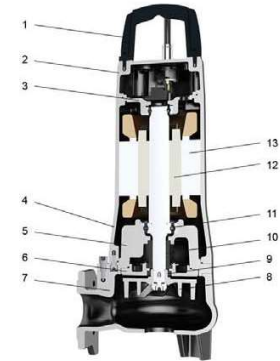

Package Information

Model	GW (Kgs)	L (mm)	W (mm)	H (mm)	Quantity (PCS/20'TEU)
50SWU9-6-0.37	36	750	290	368	372
50SWUm9-6-0.37	37	750	290	368	372
50SWU13.2-4-0.37	36	750	290	368	372
50SWUm13.2-4-0.37	37	750	290	368	372
50SWU12-8-0.75	38	750	290	368	372
50SWUm12-8-0.75	39	750	290	368	372
50SWU15-5.5-0.75	38	750	290	368	372
50SWUm15-5.5-0.75	39	750	290	368	372

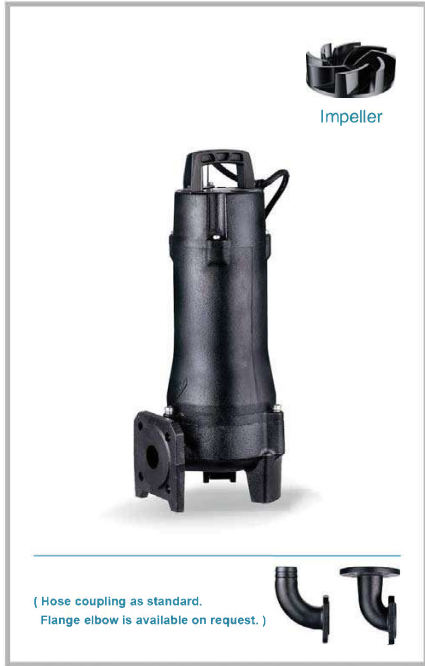

Applications

- Drainage of wastewater from the attenuation tank, purifying tank and sewage tank in water treatment plant
- Drainage of waste water containing fibrous additives from leather factory and food processing factory.
- Sewage management, accumulated water, septic tank, stock farm.
- Pumping sewage form hotels, restaurants, schools and public buildings

Pump

- Semi-open vortex impeller, suitable for liquid containing impurities and long fiber substance
- Flexible installations with hoses, pipes or quick-coupling systems
- Double-end mechanical seal
- Stainless steel welded shaft
- Liquid temperature: 0 - 40 °C
- Liquid PH value: 4 - 10
- Max. immersion depth: 5 m

Motor

- Frequency/Pole number: 50 Hz/2
- Insulation class: F
- Protection class: IPX8
- Bearing: Ball type

Identification Codes

65 SW U m 24 - 8.5 - 1.5

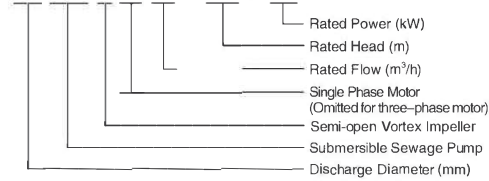

Hydraulic Performance Curves

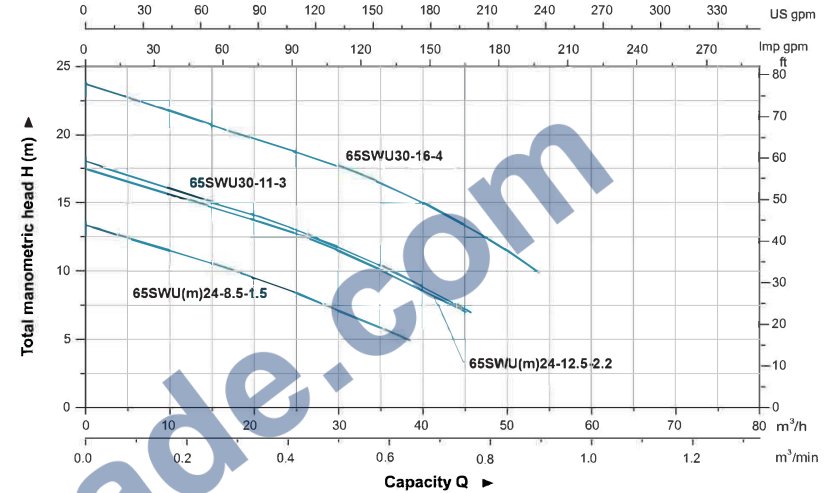

Technical Data

Model		Power		Discharge mm (inch)	Rated Flow (m³/h)	Max. Flow (m³/h)	Rated Head (m)	Max. Flow (m³/s)	Solid Passage (mm)
Single Phase	Three Phase	kW	HP						
65SWUm24-8.5-1.5	65SWU24-8.5-1.5	1.5	2	65 (2.5")	24	38	8.5	13	50
65SWUm24-12.5-2.2	65SWU24-12.5-2.2	2.2	3	65 (2.5")	24	40	12.5	17	50
-	65SWU30-11-3	3	4	65 (2.5")	30	46	11	18	55
-	65SWU30-16-4	4	5.5	65 (2.5")	30	54	16	24	55

Materials Table

No.	Part	Material
1	Handle	ZG304
2	Upper cover	HT200
3	Upper bearing seat	HT200
4	Motor body	HT200
5	Oil chamber	HT200
6	Pump cover	HT200
7	Pump body	HT200
8	Impeller	HT200
9	Oil seal	
10	Mechanical seal	Upper SiC/Carbon Lower SiC/SiC
11	Bearing	
12	Rotor	
13	Stator	

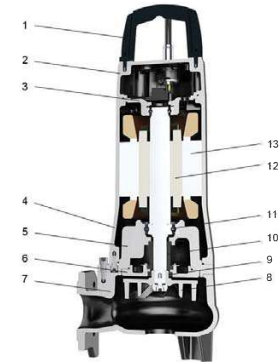

Dimension

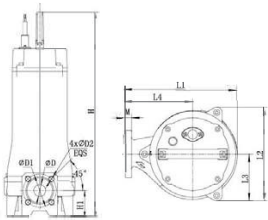

Model	L1	L2	L3	L4	H	H1	D	D1	D2	M
65SWU24-8.5-1.5					626					
65SWUm24-8.5-1.5	268	219	111	161	667	93	65	130	14	16
65SWU24-12.5-2.2					626					
65SWUm24-12.5-2.2					667					
65SWU30-11-3	260	218	118	149	806	122	80	150	18	18
65SWU30-16-4										

Package Information

Model	GW (Kgs)	L (mm)	W (mm)	H (mm)	Quantity (PCS/20' TEU)
65SWU24-8.5-1.5	58	848	358	311	294
65SWUm24-8.5-1.5	60	848	358	311	294
65SWU24-12.5-2.2	60	848	358	311	294
65SWUm24-12.5-2.2	62	918	338	306	294
65SWU30-11-3	68	848	358	311	294
65SWU30-16-4	69	918	338	306	294

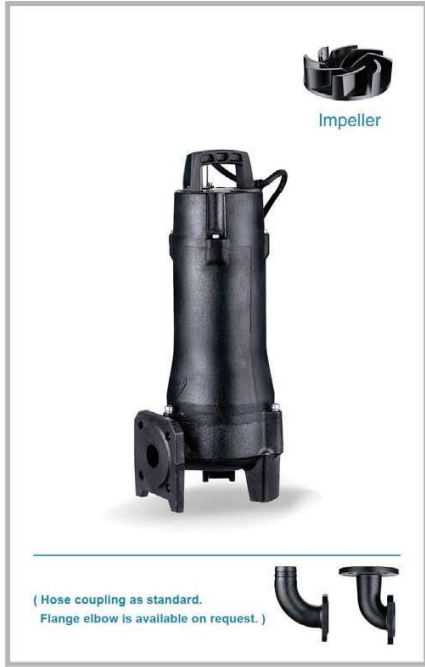

Applications

- Drainage of wastewater from the attenuation tank, purifying tank and sewage tank in water treatment plant
- Drainage of waste water containing fibrous additives from leather factory and food processing factory.
- Sewage management, accumulated water, septic tank, stock farm.
- Pumping sewage form hotels, restaurants, schools and public buildings

Pump

- Semi-open vortex impeller, suitable for liquid containing impurities and long fiber substance
- Flexible installations with hoses, pipes or quick-coupling systems
- Double-end mechanical seal
- Stainless steel welded shaft
- Liquid temperature: 0 - 40 °C
- Liquid PH value: 4 - 10
- Max. immersion depth: 5 m

Motor

- Frequency/Pole number: 50 Hz/2
- Insulation class: F
- Protection class: IPX8
- Bearing: Ball type

Identification Codes

80 SW U m 30 - 4.5 - 1.5

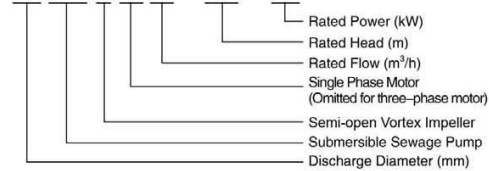

Hydraulic Performance Curves

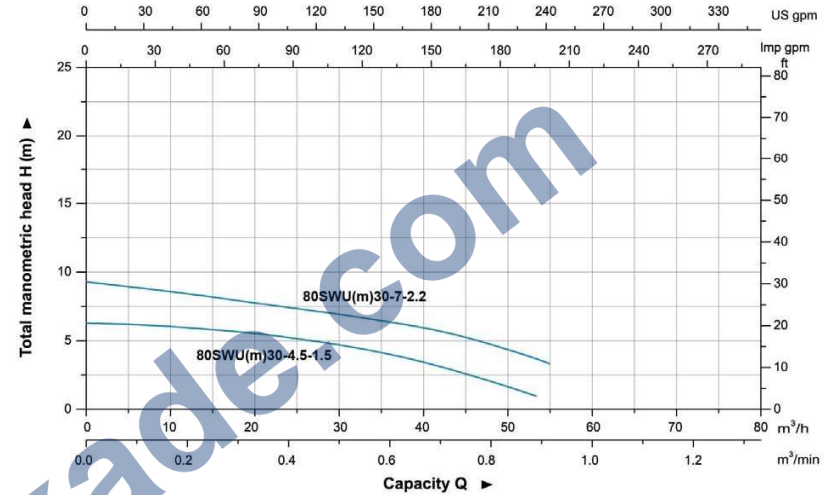

Technical Data

Model		Power		Discharge mm (inch)	Rated Flow m ³ /h	Max. Flow m ³ /h	Rated Head (m)	Max. Flow m ³ /h	Solid Passage (mm)
Single Phase	Three Phase	kW	HP						
80SWUm30-4.5-1.5	80SWU30-4.5-1.5	1.5	2	80 (3")	30	50	4.5	6	76
80SWUm30-7-2.2	80SWU30-7-2.2	2.2	3	80 (3")	30	45	7	8	76

Materials Table

No.	Part	Material
1	Handle	ZG304
2	Upper cover	HT200
3	Upper bearing seat	HT200
4	Motor body	HT200
5	Oil chamber	HT200
6	Pump cover	HT200
7	Pump body	HT200
8	Impeller	HT200
9	Oil seal	
10	Mechanical seal	Upper:SiC/Carbon Lower:SiC/SiC
11	Bearing	
12	Rotor	
13	Stator	

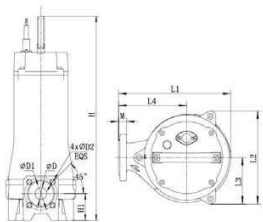
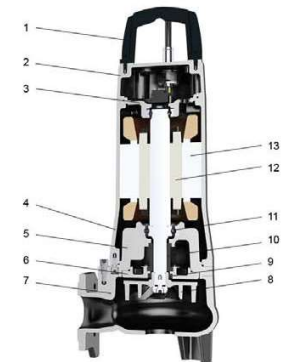

Dimension

Model	L1	L2	L3	L4	H	H1	D	D1	D2	M
80SWU30-4.5-1.5					665					
80SWUm30-4.5-1.5					706	122	80	150	18	18
80SWU30-7-2.2					665					
80SWUm30-7-2.2					706					

Package Information

Model	GW (Kgs)	L (mm)	W (mm)	H (mm)	Quantity (PCS/20 TEU)
80SWU30-4.5-1.5	58	918	338	306	294
80SWUm30-4.5-1.5	61	918	338	306	294
80SWU30-7-2.2	62	918	338	306	294
80SWUm30-7-2.2	63	918	338	306	294



SWP
Submersible Sewage Pump



Applications

- Used In pressure sewage system
- Drainage of wastewater from individual residences, apartment buildings, recreational developments, models
- Transferring wastewater of commercial buildings, industrial plants, wastewater sampling, small hospitals
- Schools, federal, state and local parks, wastewater drainage
- To transfer various wastewater and sewage

Pump

- Semi-open vortex impeller & reliable grinding system
- Flexible installations with hoses, pipes or quick-coupling systems
- Float switch as standard accessory for single phase (≤1.1kw)
- Double-end mechanical seal
- Stainless steel welded shaft
- Liquid temperature: 0 - 40 °C
- Liquid PH value: 4 - 10
- Max. immersion depth: 5 m

Motor

- Frequency/Pole number: 50 Hz/2
- Insulation class: F
- Protection class: IPX8
- Bearing: Ball type

Identification Codes

32 SW P m 3.6 - 17 - 1.1 /QG

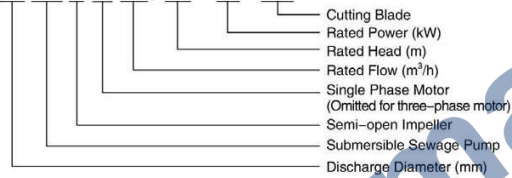

Hydraulic Performance Curves

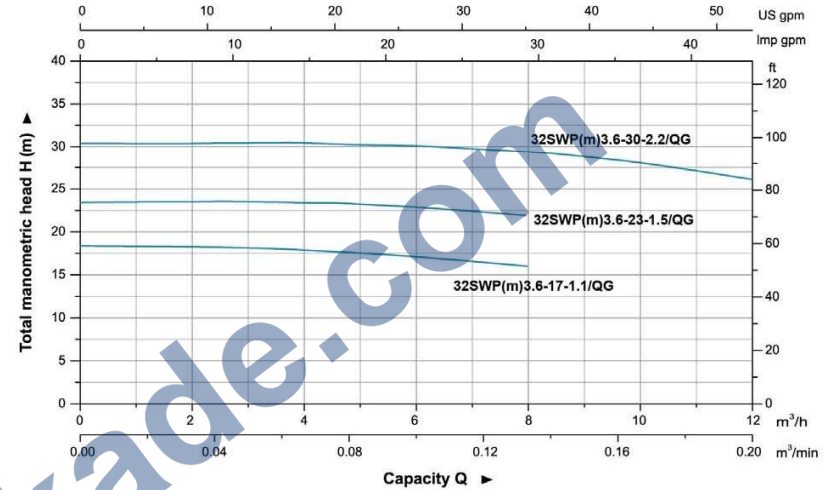

Materials Table

No.	Part	Material
1	Handle	ZG304
2	Upper cover	HT200
3	Upper bearing seat	HT200
4	Motor body	HT200
5	Oil chamber	HT200
6	Pump cover	HT200
7	Pump body	HT200
8	Impeller	HT200
9	Cutting ring	AISI304
10	Radial cutter	AISI304
11	Oil seal	
12	Mechanical seal	Upper:SiC/Carbon Lower:SiC/SiC
13	Bearing	
14	Rotor	
15	Stator	

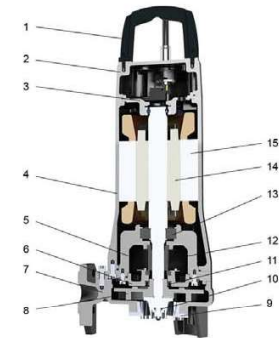

Technical Data

Model		Power		Discharge mm (inch)	Rated Flow (m³/h)	Max. Flow (m³/h)	Rated Head (m)	Max. Flow (m³/h)	Solid Passage (mm)
Single Phase	Three Phase	kW	HP						
32SWPm3.6-17-1.1/QG	32SWP3.6-17-1.1/QG	1.1	1.5	32 (1 1/4")	3.6	8	17	18	-
32SWPm3.6-23-1.5/QG	32SWP3.6-23-1.5/QG	1.5	2	32 (1 1/4")	3.6	10	23	23.2	-
32SWPm3.6-30-2.2/QG	32SWP3.6-30-2.2/QG	2.2	3	32 (1 1/4")	3.6	12	30	30.2	-

Dimension

Model	L1	L2	L3	L4	H	H1	D	D1	D2	M
32SWP3.6-17-1.1/QG					535					
32SWPm3.6-17-1.1/QG					559	73	32	90	14	16
32SWP3.6-23-1.5/QG	231	192	96	140	600					
32SWPm3.6-23-1.5/QG					559					
32SWP3.6-30-2.2/QG					600					
32SWPm3.6-30-2.2/QG										

Package Information

Model	GW (Kgs)	L (mm)	W (mm)	H (mm)	Quantity (PCS/20"TEU)
32SWP3.6-17-1.1/QG	38	848	358	311	294
32SWPm3.6-17-1.1/QG	39	848	358	311	294
32SWP3.6-23-1.5/QG	48	848	358	311	294
32SWPm3.6-23-1.5/QG	50	848	358	311	294
32SWP3.6-30-2.2/QG	50.5	848	358	311	294
32SWPm3.6-30-2.2/QG	52	848	358	311	294



SWP

Submersible Sewage Pump



Applications

- Used In pressure sewage system
- Drainage of wastewater from individual residences, apartment buildings, recreational developments, models
- Transferring wastewater of commercial buildings, industrial plants, wastewater sampling, small hospitals
- Schools, federal, state and local parks, wastewater drainage
- To transfer various wastewater and sewage

Pump

- Semi-open vortex impeller & reliable grinding system
- Flexible installations with hoses, pipes or quick-coupling systems
- Double-end mechanical seal
- Stainless steel welded shaft
- Liquid temperature: 0 - 40 °C
- Liquid PH value: 4 - 10
- Max. immersion depth: 5 m

Motor

- Frequency/Pole number: 50 Hz/2
- Insulation class: F
- Protection class: IPX8
- Bearing: Ball type

Identification Codes

50 SW P 12 – 19 – 2.2/QG

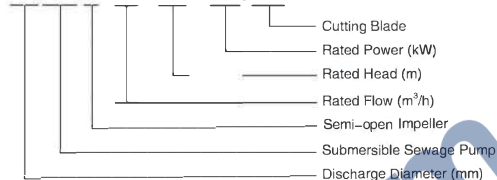

(Flange elbow as standard.)

Technical Data

Model	Power		Discharge mm (inch)	Rated Flow (m ³ /h)	Max. Flow (m ³ /h)	Rated Head (m)	Max. Head (m)	Solid Passage (mm)
	kW	HP						
50SWP12-19-2.2/QG	2.2	3	50 (2")	12	24.5	19	29	-
50SWP12-22-3/QG	3	4	50 (2")	12	26	22	29.5	-
50SWP12-30-4/QG	4	5.5	50 (2")	12	26.5	30	33	-

Dimension

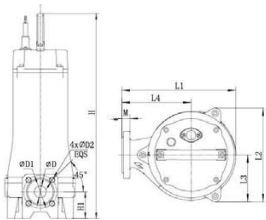

Model	L1	L2	L3	L4	H	H1	D	D1	D2	M
50SWP12-19-2.2/QG	243	212	106	145	559	73	40	100	14	16
50SWP12-22-3/QG	243	212	106	145	588	73	40	100	14	16
50SWP12-30-4/QG	243	212	106	145	588	73	40	100	14	16

Hydraulic Performance Curves

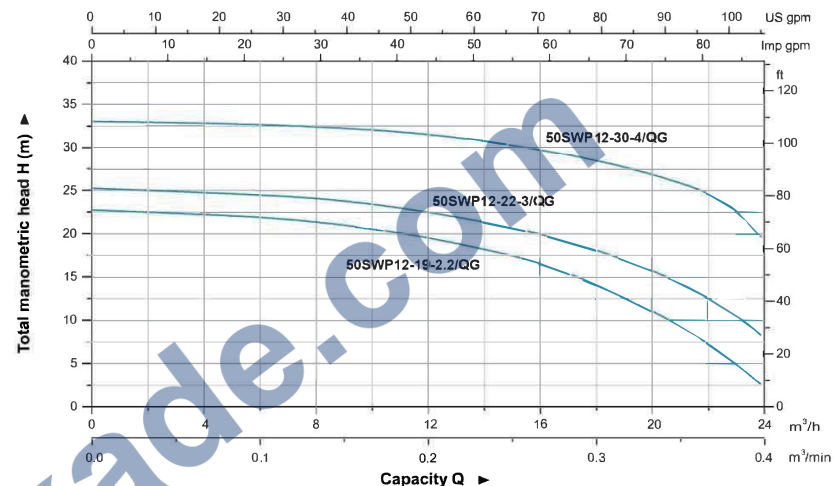

Materials Table

No	Part	Material
1	Handle	ZG304
2	Upper cover	HT200
3	Upper bearing seat	HT200
4	Motor body	HT200
5	Oil chamber	HT200
6	Pump cover	HT200
7	Pump body	HT200
8	Impeller	HT200
9	Cutting ring	AISI304
10	Radial cutter	AISI304
11	Oil seal	
12	Mechanical seal	Upper Seal:Carbon Lower Seal:SiC
13	Bearing	
14	Rotor	
15	Stator	

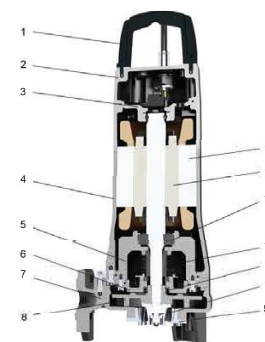

Package Information

Model	GW (Kgs)	L (mm)	W (mm)	H (mm)	Quantity (PCS/20 TEU)
50SWP12-19-2.2/QG	53	848	358	311	294
50SWP12-22-3/QG	60	848	358	311	294
50SWP12-30-4/QG	63	848	358	311	294