

LBm

Bidirectional Peripheral Pump



Features

- Multi-Applicaton:
Transfer water, wine, milk, juice and other non-aggressive liquids without sand or other solid impurities.
- Bidirectional rotation:
Motor equipped with a reverse switch to allow the pump rotate in two directions. Suction side can be used for delivery, delivery side can be used for suction.
Pump liquids out and refill without moving pipes.

Pump

- Max. Liquid temperature: 35°C
- Max. ambient temperature: 40°C
- Max. Suction: 8 m
- Equiped with reverse switch for bidirectional rotation
- AISI 304 Pump body & cover, brass impeller
- AISI304 welding shaft

Motor

- Built-in thermal protector
- Insulation class: F
- Protection class: IP 44
- 220~240V/50Hz, n=2850
- S1 continuous duty

Identification Codes

L B m 20



Technical Data

Model	Power		Q(m ³ /h)	0	0.3	0.6	0.9	1.2	1.5	1.8	2.1	2.4	2.7	3.0
	kW	HP		Q(l/min)	0	5	10	15	20	25	30	35	40	45
LBm20	0.37	0.5	H(m)	15	12.5	10	7	4	1	-	-	-	-	-
LBm25	0.75	1.0		18	17	16	14.5	13	12	10.5	9	7	5	2

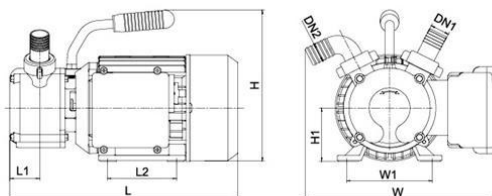

Dimension

Model	Ports		L (mm)	W (mm)	H (mm)	L1 (mm)	L2 (mm)	W1 (mm)	H1 (mm)
	DN1	DN2							
LBm20	20mm		252.5	220	182.5	31.5	80	100	63
LBm25	25mm		297.5	247	201	39	90	112	71



Hydraulic Performance Curves

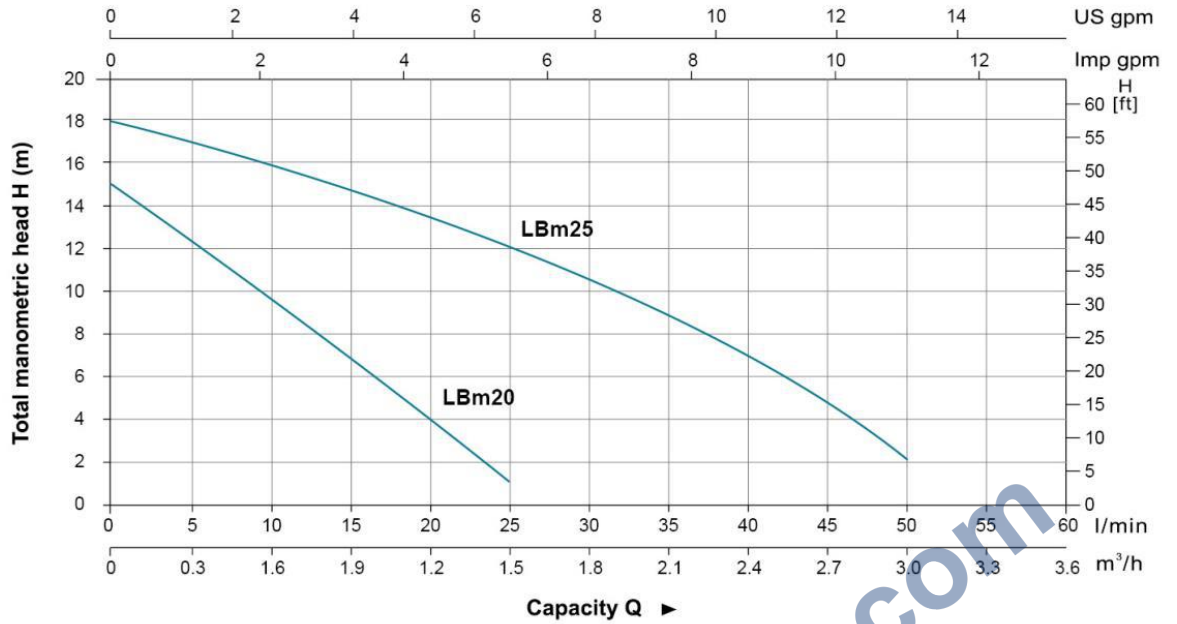

Materials Table

No.	Part	Material
1	Pump cover	AISI304
2	O-ring	NBR
3	Impeller	Brass
4	Pump body	AISI 304
5	Support	HT200
6	Skeleton seal	
7	Bearing	
8	Rotor	
9	End plate	ZL 102
10	Fan	PP-GF15
11	Wind hood	08F
12	Reversing switch	
13	Terminal box	ABS
14	Capacitor	
15	Terminal box cover	ABS
16	Handle	Steel
17	Water elbow	ZCuZn38
18	Water inlet	ZCuZn38
19	Stator	

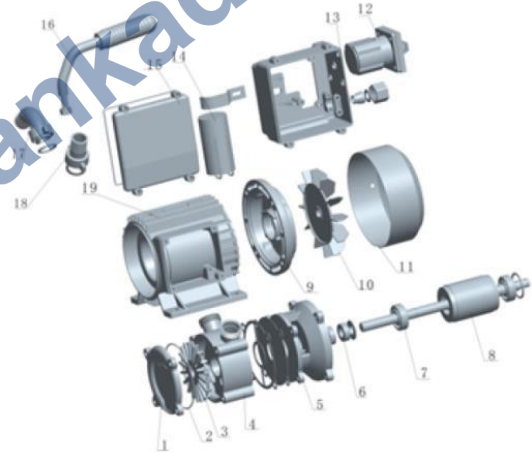

Package Information

Model	GW (kg)	L (mm)	W (mm)	H (mm)	Quantity (PCS/20 TEU)
LBm20	5.7	282	216	150	2912
LBm25	10.1	328	236	167	1872

